

DIN 94 similar to ISO 1234

Split pins

Threaded end $\approx 1,25 d$

Stainless steel A2 | Cr(VI)-free

Further information: DIN-standard has been withdrawn

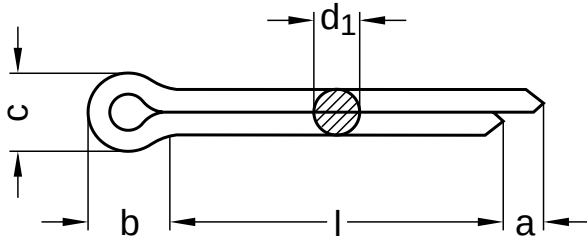

Diameter (d)	a		b nominal size	c		nominal size	d ₁	
	min.	max.		min.	max.		min.	max.
1.6	1.25	2.5	3.2	2.4	2.8	1.6	1.3	1.4
2	1.25	2.5	4.0	3.2	3.6	2	1.7	1.8
2.5	1.25	2.5	5.0	4.0	4.6	2.5	2.1	2.3
3.2	1.60	3.2	6.4	5.1	5.8	3.2	2.7	2.9
4	2.00	4.0	8.0	6.5	7.4	4	3.5	3.7
5	2.00	4.0	10.0	8.0	9.2	5	4.4	4.6
6.3	2.00	4.0	12.6	10.3	11.8	6.3	5.7	5.9
8	2.00	4.0	16.0	13.1	15.0	8	7.3	7.5
10	3.20	6.3	20.0	16.6	19.0	10	9.3	9.5

nominal size	Length (l)	
	min.	max.
8	7.25	8.75
10	9.25	10.75
12	11.10	12.90
14	13.10	14.90
16	15.10	16.90
18	17.10	18.90
20	19.00	21.00
22	21.00	23.00

nominal size	Length (l)	
	min.	max.
25	24.00	26.00
28	27.00	29.00
32	30.75	33.25
36	34.75	37.25
40	38.75	41.25
45	43.75	46.25
50	48.75	51.25
56	54.50	57.50

nominal size	Length (l)	
	min.	max.
63	61.50	64.50
71	69.50	72.50
80	78.50	81.50
90	88.25	91.75
100	98.25	101.75

All technical data refer to the measure mm



DIN 94 similar to ISO 1234

Split pins

Threaded end $\approx 1,25 d$

Stainless steel A2 | Cr(VI)-free

Diameter (d)	Length (l)																					
	8	10	12	14	16	18	20	22	25	28	32	36	40	45	50	56	63	71	80	90	100	
1.6	●	●	●	●	●	●	●	●	●	●	●											
2		●	●	●	●	●	●	●	●	●	●	●	●									
2.5			●	●	●	●	●	●	●	●		●	●	●	●							
3.2					●	●	●	●	●	●	●	●	●	●	●	●	●	●	●			
4									●	●	●	●	●	●	●	●	●	●	●	●	●	●
5							●	●	●	●	●	●	●	●	●	●	●	●	●	●	●	●
6.3										●	●	●	●	●	●	●	●	●	●	●	●	●
8												●	●									
10																			●	●	●	●

• Combinations available in the eShop | Other sizes on request

All technical data refer to the measure mm

