

DIN 7984
Cylinder screws

Hexagon socket | low head

Steel 08.8 | zinc-plated, thick-film passivated (VZD) | Cr(VI)-free | Metric thread

Further information: Due to their head geometry, these screws are limited in their load bearing capacity, see DIN EN ISO 898-1

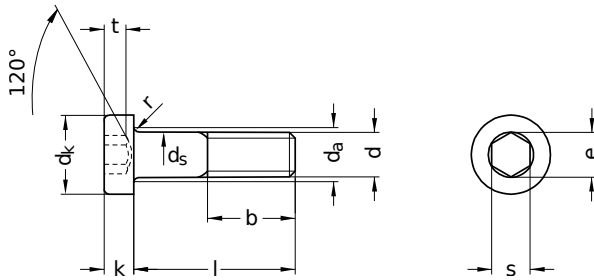

Diameter (d)	b			d _a max.	d _k		d _s		k	
	l up to 125	l up to 200	l longer than 200		min.	max.	min.	max.	min.	max.
M8	22	28	–	9.2	12.73	13	7.78	8	4.82	5
M16	38	44	57	17.7	23.67	24	15.73	16	8.78	9
M24	54	60	73	26.4	35.61	36	23.67	24	12.73	13

Diameter (d)	e min.	r min.	s			Pitch (P)	t			Tool size
			nominal size	min.	max.		nominal size	max.	min.	
M8	5.72	0.4	5	5.02	5.12	1.25	3.8	3.95	3.65	SW 5
M16	13.72	0.6	12	12.03	12.21	2.00	5.5	5.65	5.35	SW 12
M24	19.44	0.8	17	17.05	17.23	3.00	8.0	8.18	7.82	SW 17

nominal size	Length (l)	
	min.	max.
25	24.58	25.42
35	34.50	35.50
55	54.50	55.50

Diameter (d)	Length (l)		
	25	35	55
M8	●		
M16		●	
M24			●

● Combinations available in the eShop | Other sizes on request

All technical data refer to the measure mm

