

DIN 6921 similar to EN 1665

Hexagon head bolts

With flange | hexagon head

Steel 8.8 | zinc-plated | Cr(VI)-free | Metric thread

Further information: DIN-standard has been withdrawn | different spanner widths for M10, M12, M14 and M22 | changed head height

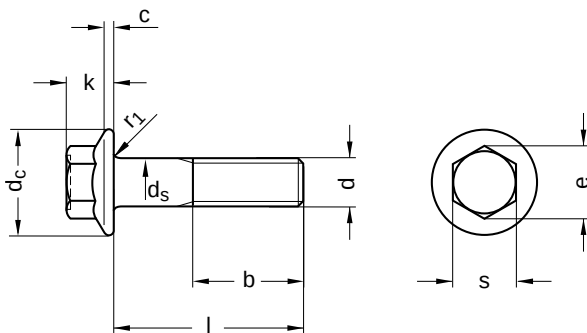

Diameter (d)	b			c min.	d _c max.	d _s	
	l up to 125	l up to 200	l longer than 200			min.	max.
M5	16	–	–	1.0	11.8	4.82	5
M6	18	–	–	1.1	14.2	5.82	6
M8	22	28	–	1.2	18.0	7.78	8
M10	26	32	–	1.5	22.3	9.78	10
M12	30	36	–	1.8	26.6	11.73	12
M16	38	44	57	2.4	35.0	15.73	16

Diameter (d)	k max.	e min.	r ₁ nominal size	s		Pitch (P)	Tool size
				min.	max.		
M5	5.4	8.71	0.25	7.78	8	0.80	SW 8
M6	6.6	10.95	0.40	9.78	10	1.00	SW 10
M8	8.1	14.26	0.40	12.73	13	1.25	SW 13
M10	9.2	16.50	0.40	14.73	15	1.50	SW 15
M12	11.5	17.62	0.60	15.73	16	1.75	SW 16
M16	14.4	23.15	0.60	20.67	21	2.00	SW 21

nominal size	Length (l)	
	min.	max.
12	11.65	12.35
16	15.65	16.35
20	19.58	20.42
25	24.58	25.42
30	29.58	30.42
35	34.50	35.50
40	39.50	40.50
45	44.50	45.50

nominal size	Length (l)	
	min.	max.
50	49.50	50.50
55	54.40	55.60
60	59.40	60.60
70	69.40	70.60
80	79.40	80.60

All technical data refer to the measure mm



DIN 6921 similar to EN 1665

Hexagon head bolts

With flange | hexagon head

Steel 8.8 | zinc-plated | Cr(VI)-free | Metric thread

Diameter (d)	Length (l)												
	12	16	20	25	30	35	40	45	50	55	60	70	80
M5	●							●					
M6	●	●	●	●	●	●					●		
M8	●	●	●	●	●	●	●					●	
M10			●	●	●	●	●		●				●
M12				●	●	●	●						
M16							●				●		

• Combinations available in the eShop | Other sizes on request

All technical data refer to the measure mm

