

DIN 661
Countersunk head rivets

Stainless steel A2 | Cr(VI)-free

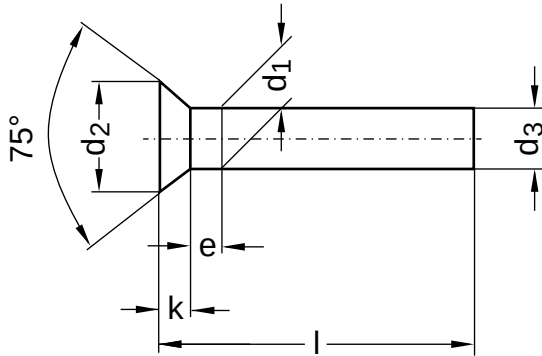

Diameter (d)	nominal size	d ₁		d ₂ nominal size	d ₃ min.	e max.	k nominal size
		min.	max.				
2	2	1.90	2.10	3.5	1.87	1.0	1.0
3	3	2.90	3.10	5.2	2.87	1.5	1.4
4	4	3.90	4.10	7	3.81	2.0	2.0
5	5	4.85	5.15	8.8	4.82	2.5	2.5
6	6	5.85	6.15	10.5	5.82	3.0	3.0

Length (l)		Length (l)	
nominal size	max.	nominal size	max.
6	6.30	18	18.43
8	8.36	20	20.52
10	10.36	25	25.52
12	12.43	30	30.52
15	15.43	35	35.62
16	16.43	40	40.62

Diameter (d)	Length (l)											
	6	8	10	12	15	16	18	20	25	30	35	40
2	●	●	●	●	●	●	●	●	●			
3	●	●	●	●		●	●	●	●			
4	●	●	●	●	●	●	●	●	●	●	●	
5		●	●	●	●	●	●	●	●	●	●	●
6			●	●	●	●	●	●	●	●	●	●

• Combinations available in the eShop | Other sizes on request

All technical data refer to the measure mm

