

**DIN 1476** similar to ISO 8746

## Round head grooved pins

Round head

Steel | bright | Cr(VI)-free

Further information: DIN standard has been withdrawn

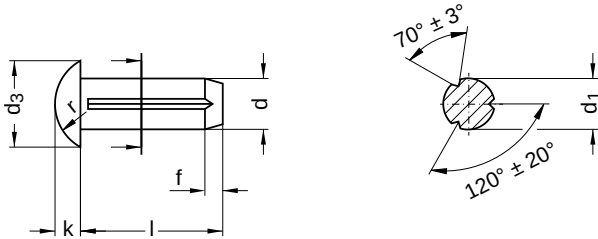

Diameter (d)	d <sub>1</sub>		nominal size	d <sub>3</sub>		f	nominal size	k		r
	min.	max.		min.	max.			min.	max.	
1.4	1.35	1.4	2.4	2.20	2.60	0.5	0.8	0.70	0.90	1.4
1.6	1.55	1.6	2.8	2.60	3.00	0.5	1.0	0.90	1.10	1.6
2	1.95	2.0	3.5	3.30	3.70	0.5	1.2	1.10	1.30	1.9
2.5	2.42	2.5	4.4	4.20	4.60	0.7	1.5	1.40	1.60	2.4
3	2.92	3.0	5.2	4.95	5.45	1.0	1.8	1.65	1.95	2.8
4	3.90	4.0	7	6.75	7.25	1.5	2.4	2.25	2.55	3.8
5	4.90	5.0	8.8	8.50	9.10	1.5	3.0	2.85	3.15	4.6
6	5.90	6.0	10.5	10.20	10.80	2.0	3.6	3.45	3.75	5.7

nominal size	Length (l)	
	min.	max.
3	2.76	3.24
4	3.76	4.24
5	4.76	5.24
6	5.76	6.24
7	6.71	7.29
8	7.71	8.29
10	9.71	10.29
12	11.65	12.35

nominal size	Length (l)	
	min.	max.
15	14.65	15.35
18	17.65	18.35
20	19.58	20.42
22	21.58	22.42
25	24.58	25.42
28	27.58	28.42
30	29.58	30.42

All technical data refer to the measure mm



**DIN 1476** similar to ISO 8746

# Round head grooved pins

Round head

Steel | bright | Cr(VI)-free

Diameter (d)	Length (l)														
	3	4	5	6	7	8	10	12	15	18	20	22	25	28	30
1.4	●		●												
1.6	●	●	●	●											
2	●	●	●	●	●	●	●								
2.5	●	●	●	●	●	●	●								
3		●	●	●	●	●	●	●							
4				●	●	●	●	●	●	●	●				
5						●	●	●	●	●	●	●	●		
6							●	●	●	●	●	●	●	●	●

• Combinations available in the eShop | Other sizes on request

All technical data refer to the measure mm

